

**AMENDED  
DRAWING**

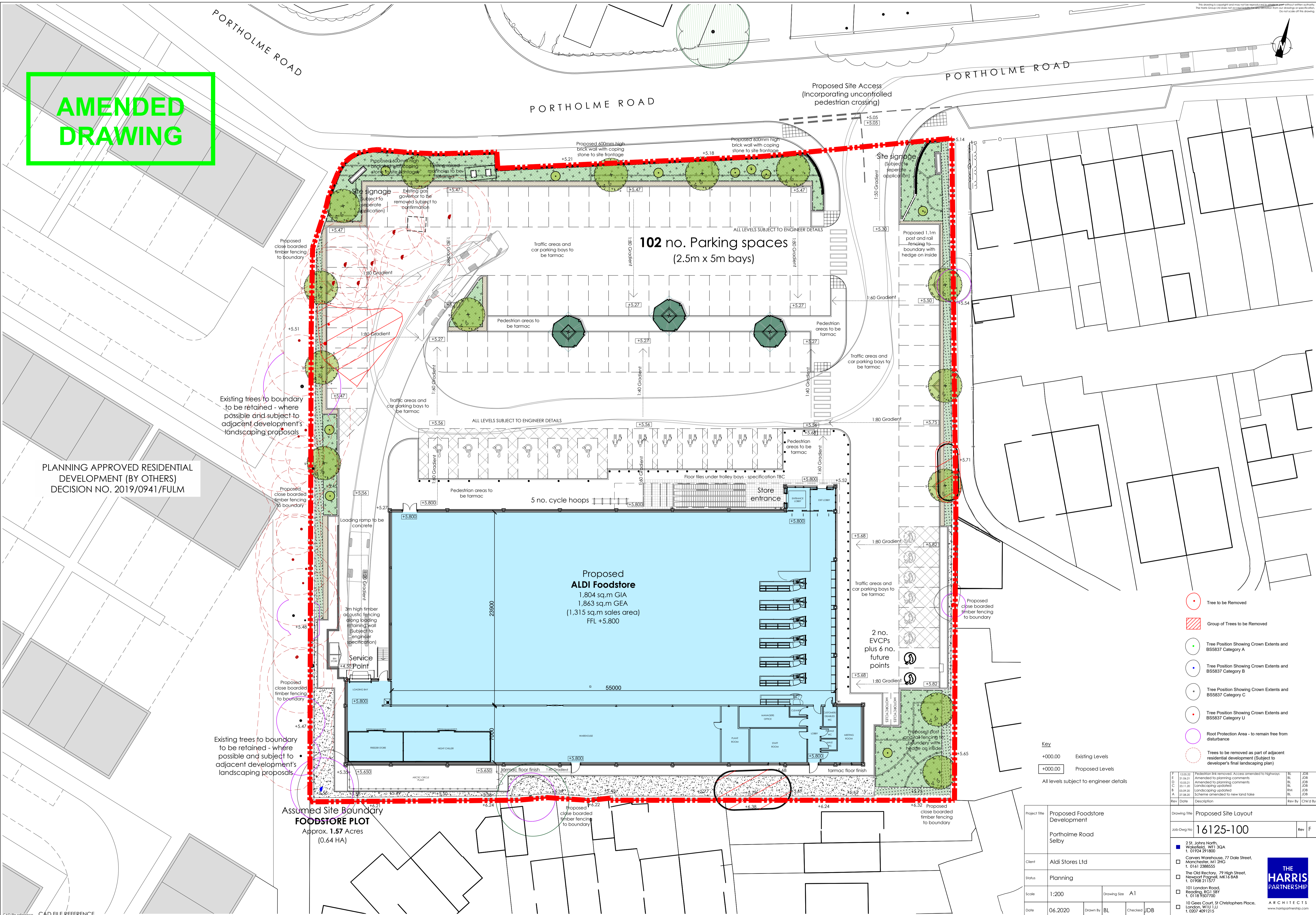

PLANNING APPROVED RESIDENTIAL DEVELOPMENT (BY OTHERS) DECISION NO. 2019/0941/FULM

Assumed Site Boundary  
**FOODSTORE PLOT**  
Approx. 1.57 Acres  
(0.64 HA)

- Tree to be Removed
- Group of Trees to be Removed
- Tree Position Showing Crown Extents and BS5837 Category A
- Tree Position Showing Crown Extents and BS5837 Category B
- Tree Position Showing Crown Extents and BS5837 Category C
- Tree Position Showing Crown Extents and BS5837 Category U
- Root Protection Area - to remain free from disturbance
- Trees to be removed as part of adjacent residential development (Subject to developer's final landscaping plan)

**Key**  
+000.00 Existing Levels  
+000.00 Proposed Levels  
All levels subject to engineer details

Rev	Date	Description	Rev	Check
F	12.03.22	Proposed site removed. Access amended to highways	BL	JDB
E	27.04.21	Amended to planning comments	BL	JDB
D	10.03.21	Amended to planning comments	BL	JDB
C	23.11.20	Landscaping updated	BL	JDB
B	03.09.20	Landscaping updated	RM	JDB
A	27.09.20	Scheme amended to new land take	BL	JDB

Project Title	Proposed Foodstore Development		
Client	Aldi Stores Ltd		
Status	Planning		
Scale	1:200	Drawing Size	A1
Date	06.2020	Drawn By	BL
		Checked	JDB
Job-Dwg No.	16125-100	Rev	F
Drawing Title	Proposed Site Layout		
<ul style="list-style-type: none"> <li><span style="color: blue;">■</span> 2 St. Johns North, Wakefield, WF1 3GA t. 01924 291800</li> <li><input type="checkbox"/> Carvers Warehouse, 77 Dale Street, Manchester, M1 2HG t. 0161 238855</li> <li><input type="checkbox"/> The Old Rectory, 79 High Street, Newport Pagnell, MK16 6AB t. 01908 211577</li> <li><input type="checkbox"/> 101 London Road, Reading, RG1 8BT t. 0118 9507700</li> <li><input type="checkbox"/> 10 Goss Court, St Christophers Place, London, W1U 1JJ t. 0207 4091215</li> </ul>			
<b>THE HARRIS PARTNERSHIP</b>		ARCHITECTS	